

Using your Video Baby Monitor

In this section you'll find out how to use your baby monitor to make sure you get the best possible use out of it.

To start using your baby monitor, you'll need to turn both units on. You'll see where the Power buttons are located in the diagrams.

The features outlined below are all accessible through the **MENU** which can be opened by pressing the **Menu** button, using the **<** and **>** buttons to navigate, **^** and **v** to scroll through the sub menus and **OK** to select the desired option. To return to the camera feed, simply press the **Menu** button.

Monitoring volume and mute

There are 8 volume settings. The default is 4.

1. In normal monitor mode (**X1**), press **^** or **v** to change the volume.
2. Press **OK** to confirm.
3. To turn the sound off completely, turn the volume down to 0. **🔇** will be displayed on top of the screen.

Screen brightness

There are 8 brightness levels. The default is 4.

1. In normal monitor mode (**X1**), press **<** or **>** to select the brightness level.
2. Press **OK** to confirm.

Lullabies

There are 5 lullabies to choose from or you can play all 5 in sequence.

1. Press **Menu**, **🎵** is displayed, press **OK**.
2. Press **^** or **v** to choose the lullaby 1-5 or press **🎵** to play all five, then press **OK**.
3. Press **^** or **v** to select the volume from 1-3 and press **OK** to save.
4. To stop the lullaby playing, select **🔇**.

Talk to your baby

To give your baby some words of comfort, press and hold down **Talk** on the parent unit and speak into the parent unit's microphone. The **🗣️** icon will be displayed at the bottom right corner. Release the button when you've finished speaking.

Zoom in/out

1. To enter zoom mode, press **Menu**, press **>** to display **🔍** and press **OK**.
2. Press **^** or **v** to select the zoom level and press **OK** to save. Press **Menu** to return back to the camera feed.

When in **X2** mode you are able to move the picture using **^**, **v**, **<** or **>**.

To adjust the volume or screen brightness, press **Menu** and select **🔊** or **🌞** and press **OK**.

Set a reminder

You can set an alert to remind you of something you need to do, for example when your baby's next feed is due. You can set it for 2, 4 or 6 hours.

1. Press **Menu**, then press **v** to display **🕒** and press **OK**.
2. Press **^** or **v** to select the reminder time (**2H**, **4H** or **6H**), then press **OK** to save. The **🕒** will be displayed on the top right of the screen.
3. To cancel the alert, select **🔇**.

Set the screen to turn on and off automatically

You can set the screen to turn on by pressing any button. On this setting, the screen will turn off automatically when no button is pressed during 1, 3 or 5 minutes.

1. Press **Menu**, then press **v** to display **📺** and press **OK**.
2. Press **^** and **v** to select **1**, **3** or **5** minutes and press **OK**.
3. To turn the screen back on at any time, press any button. If you want to set the screen on all the time, set the screen setting **📺** to off **🔇**.

Turn sound activated screen mode on or off

When set to On, the screen will turn on if noise is detected from the baby unit. If it's set to Off, the screen will stay off even if noise is detected. To use this feature, you need to set the standby mode first to 1, 3 or 5 minutes as described above.

1. Press **Menu**, then press **v** to display **🔊** and press **OK**.
2. Press **^** or **v** to select **✓** (for On) or **✗** (for Off) and press **OK**.
3. To turn the screen back on at any time, press the **📺**.

Temperature sensor

The reading from the temperature sensor will be displayed at the top of the parent unit screen.

To change the temperature display from C to F:

1. Press **Menu**, then press **v** to display **🌡️** and press **OK**.
2. Press **^** or **v** to select **°C** or **°F**, then press **OK**.

Night vision

So that you can see your baby at night, the baby unit automatically uses the light from its infrared LED lights to capture images in a dark room. Because of that, it can only show images in black and white. The **🌙** icon will be displayed at the top of the screen.

Other screen icon descriptions

- 📶** Signal strength
- 🗣️** Sound on
- 🔇** Mute
- 📺** Baby unit switched on
- 🔋** Battery status (Full battery shown, scrolling when charging)
- 📷** Camera identification number e.g. Camera 1

Get to know your Video Baby Monitor

Find out how your baby monitor works by familiarising yourself with the buttons and lights.

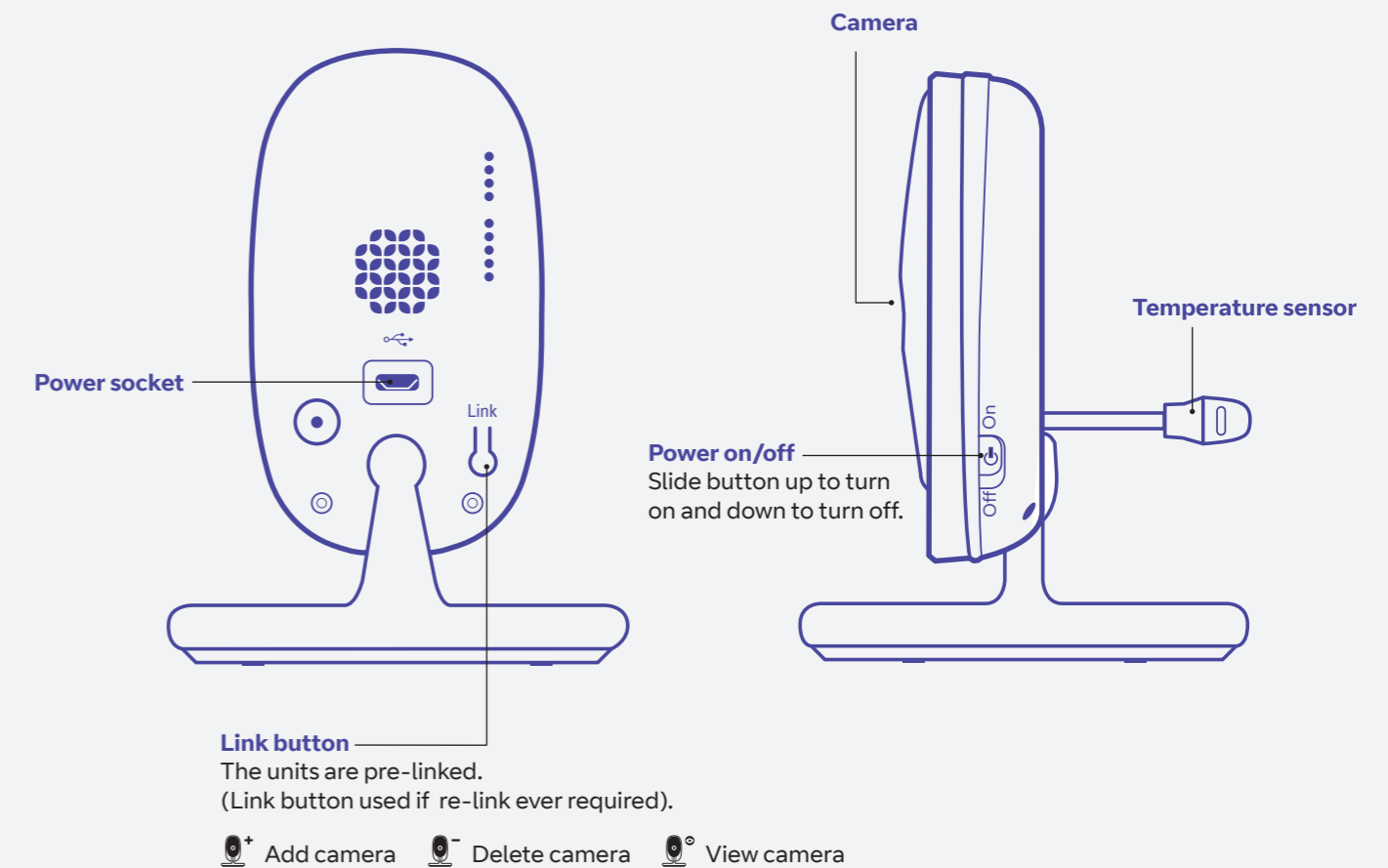

Sound level display

LED lights show the level of sound being detected from the baby unit.

Power on light

Green when parent unit turned on. (Remains green for one minute while charging, after the parent unit is turned off).

Talk

Press and hold to talk to your baby.

OK

Press to select an option in the menu. Press to enter pan and tilt mode, then use the arrows to move the camera.

